

SUSFBN80B

SUS FBN Stainless Steel Finished Bore Sprocket New JIS Keyway Specification

Order Product Code

SUSFBN80B 15 D30

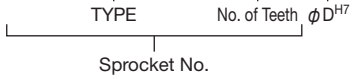

- Chain No.80
- Chain Pitch (P) 25.4 mm
- Roller Link Inner Width (W) 15.88 mm
- Roller Outside Diameter (Dr) 15.88 mm
- Tooth Width (T) 14.6 mm

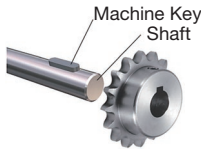

Use together with the KANA machine key.
Refer to P.334 to P.335

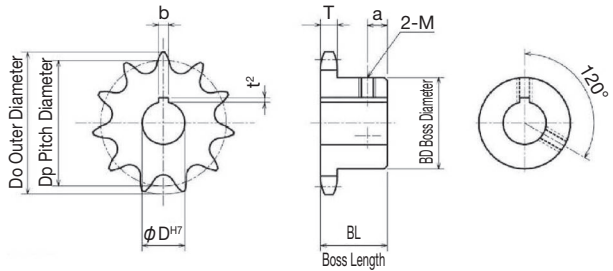

TYPE	SUSFBN80B										
											m Stainless Steel GB 304
Product Code	No. of Teeth	φ D ^{H7}	Keyway b×t ²	M	Do	Dp	BD	BL	a	Weight kg	
SUSFBN80B10D25	10	25	8×3.3	8	93	82.19	52	40	12	1.02	
SUSFBN80B10D30	10	30	8×3.3	8	93	82.19	52	40	12	1.02	
SUSFBN80B12D25	12	25	8×3.3	8	110	98.14	67	40	12	1.60	
SUSFBN80B12D30	12	30	8×3.3	8	110	98.14	67	40	12	1.60	
SUSFBN80B13D25	13	25	8×3.3	8	118	106.14	77	40	12	1.90	
SUSFBN80B13D30	13	30	8×3.3	8	118	106.14	77	40	12	1.90	
SUSFBN80B14D25	14	25	8×3.3	8	127	114.15	77	40	12	2.15	
SUSFBN80B14D30	14	30	8×3.3	8	127	114.15	77	40	12	2.15	
SUSFBN80B15D25	15	25	8×3.3	8	135	122.17	93	40	12	2.30	
SUSFBN80B15D30	15	30	8×3.3	8	135	122.17	93	40	12	2.30	
SUSFBN80B16D30	16	30	8×3.3	8	143	130.20	93	40	12	2.50	
SUSFBN80B16D35	16	35	10×3.3	8	143	130.20	93	40	12	2.50	
SUSFBN80B20D35	20	35	10×3.3	8	176	162.37	93	40	12	3.60	
SUSFBN80B20D40	20	40	12×3.3	8	176	162.37	93	40	12	3.60	

*M is a set screw. * The seal set screws differ from the usual due to the boss type.



*Products with long screw holes also include products subject to counter boring

Caution