

# SUS2062B

## SUS Standard Stainless Steel Double Pitch Sprocket for R Rollers B-type

### Order Product Code

**SUS2062B 12**

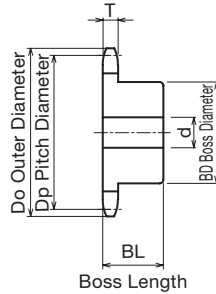
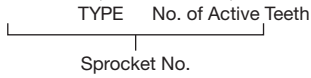

- Chain ..... **No.C2062H**
- Chain Pitch ..... **(P) 38.10 mm**
- Roller Link Inner Width ..... **(W) 12.70 mm**
- Roller Outside Diameter ..... **(Dr) 22.23 mm**
- Tooth Width ..... **(T) 11.7 mm**

**m** Stainless Steel **GB** 304

TYPE	No. of Active Teeth	Do	Dp	Shaft Hole Diameter d			BD	BL	Shape	Weight kg
				Prepared Hole	Minimum	Maximum				
<b>SUS2062B</b>	10	140	123.294	25	26	55	83	45	Ground Specification	2.50
	11	153	135.235	25	26	55	83	45		2.60
	12	165	147.207	25	26	55	83	45		2.80
	13	177	159.204	25	26	55	83	45		3.10

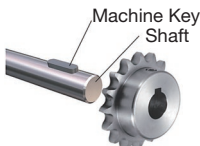

Use together with the KANA machine key.  
Refer to P.334 to P.335