

SUS2050B

SUS Standard Stainless Steel Double Pitch Sprocket for S Rollers B-type

● Order Product Code

SUS2050B 9 1/2

TYPE No. of Active Teeth
 └──────────┬──────────┘
 Sprocket No.

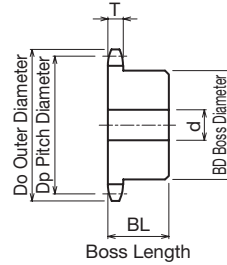

- Chain **No.C2050**
- Chain Pitch **(P) 31.75 mm**
- Roller Link Inner Width **(W) 9.53 mm**
- Roller Outside Diameter **(Dr) 10.16 mm**
- Tooth Width **(T) 8.7 mm**

m Stainless Steel **GB** 304

TYPE	No. of Active Teeth	Actual No. of Teeth	Do	Dp	Shaft Hole Diameter d			BD	BL	Shape	Weight kg
					Prepared Hole	Minimum	Maximum				
SUS2050B	9 1/2	19	105	97.783	14	15	48	73	28	Ground Specification	1.10
	10 1/2	21	115	107.717	14	15	48	73	28		1.62
	11 1/2	23	125	117.681	16	17	48	73	28		1.74
	12 1/2	25	135	127.669	16	17	48	73	28		1.87

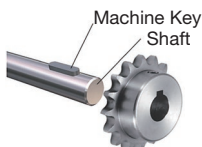

Use together with the KANA machine key.
 Refer to P.334 to P.335