

# SUS2042B

## SUS Standard Stainless Steel Double Pitch Sprocket for R Rollers B-type

### Order Product Code

**SUS2042B 12**

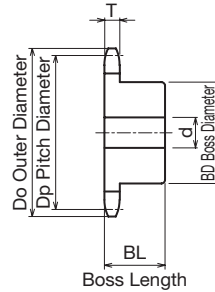
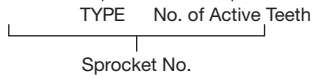

- Chain ..... **No. C2042**
- Chain Pitch ..... **(P) 25.4 mm**
- Roller Link Inner Width ..... **(W) 7.95 mm**
- Roller Outside Diameter ..... **(Dr) 15.88 mm**
- Tooth Width ..... **(T) 7.2 mm**

**m** Stainless Steel **GB** 304

TYPE	No. of Active Teeth	Do	Dp	Shaft Hole Diameter d			BD	BL	Shape	Weight kg
				Prepared Hole	Minimum	Maximum				
<b>SUS2042B</b>	10	93	82.196	15	16	42	63	25	Ground Specification	0.70
	11	102	90.156	15	16	42	63	25		0.77
	12	108	98.138	15	16	42	63	25		0.84
	13	118	106.136	16	17	42	63	25		0.97

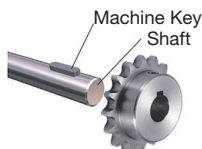

Use together with the KANA machine key.  
Refer to P.334 to P.335