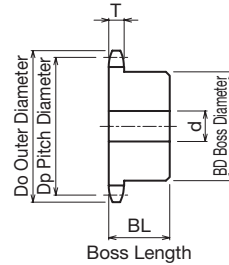
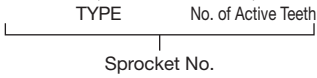

SUS2040B

SUS Standard Stainless Steel Double Pitch Sprocket for S Rollers B-type

● Order Product Code

SUS2040B 9 1/2

- Chain **No.C2040**
- Chain Pitch **(P) 25.4 mm**
- Roller Link Inner Width **(W) 7.95 mm**
- Roller Outside Diameter **(Dr) 7.92 mm**
- Tooth Width **(T) 7.2 mm**

m Stainless Steel **GB** 304

TYPE	No. of Active Teeth	Actual No. of Teeth	Do	Dp	Shaft Hole Diameter d			BD	BL	Shape	Weight kg
					Prepared Hole	Minimum	Maximum				
SUS2040B	9 1/2	19	84	78.226	14	15	38	60	25	Ground Specification	0.64
	10 1/2	21	92	86.173	14	15	46	69	25		0.93
	11 1/2	23	99	94.145	14	15	51	77	25		0.99
	12 1/2	25	108	102.135	14	15	42	63	25		1.06

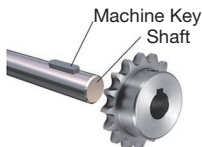

Use together with the KANA machine key.
Refer to P.334 to P.335