

# NK80B

## ● Order Product Code

### NK80B 20

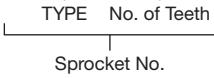

Ground Specification

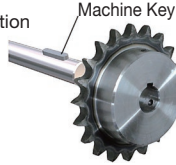

Machine Key



**Welded Specification**  
(Black stain also mixed in)

- Chain ..... **No.80**
- Chain Pitch ..... **(P) 25.4 mm**
- Roller Link Inner Width ..... **(W) 15.88 mm**
- Roller Outside Diameter ..... **(Dr) 15.88 mm**
- Tooth Width ..... **(T) 14.6 mm**

Use together with the KANA machine key. Refer to P.334 to P.335

TYPE	No. of Teeth	Do	Dp	Shaft Hole Diameter d			BD	BL	Shape	Tooth Section	Weight kg
				Prepared Hole	Minimum	Maximum					
NK80B	8	77	66.373	14	15	22	★49	40	Ground Specification	Carbon Structural Steel High-frequency Hardened Teeth	0.70
	9	85	74.265	14	15	35	★58	40			0.87
	10	93	82.196	15	16	32	52	40			1.02
	11	102	90.156	15	16	38	60	40			1.25
	12	110	98.138	15	16	45	67	40			1.60
	13	118	106.136	16	17	51	77	40			1.90
	14	127	114.147	16	17	51	77	40			2.15
	15	135	122.167	20	21	63	93	40			2.30
	16	143	130.196	20	21	63	93	40			2.50
	17	151	138.232	20	21	63	93	40			2.95
	18	159	146.273	20	21	63	93	40			3.15
	19	167	154.319	20	21	63	93	40			3.40
	20	176	162.368	20	21	63	93	40			3.60
	21	184	170.421	20	21	63	93	40			3.85
	22	192	178.478	26	27	75	107	45			5.00
	23	200	186.536	26	27	75	107	45			5.23
	24	208	194.597	26	27	75	107	45			5.50
	25	216	202.660	26	27	75	107	45			5.80
	26	224	210.724	26	27	75	107	45			6.10
	27	233	218.790	26	27	75	107	45			6.40
	28	241	226.858	26	27	75	107	45			6.75
	29	249	234.926	26	27	75	107	45			7.10
	30	257	242.996	26	27	75	107	45			7.40
	31	265	251.067	26	27	75	107	45			7.80
	32	273	259.138	26	27	75	107	45			8.15
	33	281	267.211	26	27	75	107	45			8.50
	34	289	275.284	26	27	75	107	45			8.90
	35	297	283.358	26	27	75	107	45			9.30

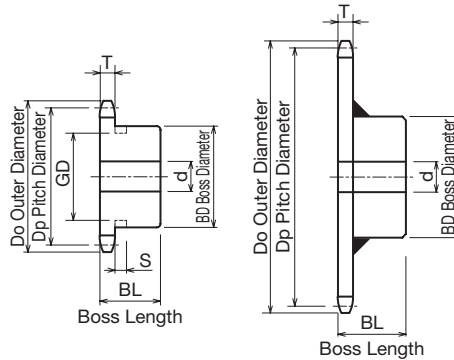
## Standard Sprocket B-type



Ground Specification

Welded Specification

TYPE	No. of Teeth	Do	Dp	Shaft Hole Diameter d			BD	BL	Shape	Tooth Section	Weight kg
				Prepared Hole	Minimum	Maximum					
NK80B	36	306	291.432	26	27	80	117	50	Ground Specification	 Carbon Structural Steel High-frequency Hardened Teeth	10.60
	37	314	299.507	26	27	80	117	50			11.00
	38	322	307.583	26	27	80	117	50			11.40
	39	330	315.659	26	27	80	117	50			11.90
	40	338	323.736	26	27	80	117	50			12.40
	41	346	331.813	26	27	80	117	50			12.80
	42	354	339.890	26	27	80	117	50			13.30
	43	362	347.968	26	27	80	117	50			13.80
	44	370	356.046	26	27	80	117	50			14.30
	45	378	364.124	26	27	80	117	50			14.90
	46	387	372.203	26	27	80	117	50	Welded Specification	 Common Steel	15.30
	47	395	380.281	26	27	80	117	50			15.70
	48	403	388.361	26	27	80	117	50			15.80
	50	419	404.520	26	27	80	117	50			17.65
	52	435	420.680	26	27	80	117	50			18.70
	53	443	428.760	26	27	80	117	50			19.30
	54	451	436.840	26	27	80	117	50			20.00
	55	459	444.921	26	27	80	117	50			20.60
	56	468	453.002	26	27	80	117	50			21.30
	58	484	469.164	26	27	80	117	50			22.55
59	492	477.245	26	27	80	117	50	22.50			
60	500	485.326	26	27	80	117	50	23.10			
65	540	525.734	26	27	89	127	63	29.40			
70	581	566.145	26	27	89	127	63	32.10			
75	621	606.558	26	27	89	127	63	36.20			
80	662	646.972	26	27	95	137	71	42.90			
90	743	727.804	26	27	95	137	71	53.00			

**I** Sprockets with a ★ symbol for BD have a channel in the boss exterior.

No. of Teeth	S	GD
8	10.4	35
9		44

