

NK15B

Micropitch Sprocket B-type

Order Product Code

NK15B 12

TYPE No. of Teeth
Sprocket No.

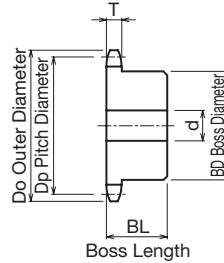

- Chain **No.15**
- Chain Pitch **(P) 4.7625 mm**
- Bushing Link Inner Width **(W) 2.38 mm**
- Bushing Outside Diameter **(Dr) 2.48 mm**
- Tooth Width **(T) 2.0 mm**

m Carbon Structural Steel

TYPE	No. of Teeth	Do	Dp	Shaft Hole Diameter d			BD	BL	Shape	Weight g
				Prepared Hole	Minimum	Maximum				
NK15B	11	19.0	16.904	4	5	7	11	10	Ground Specification	9
	12	20.5	18.401	4	5	8	12	10		10
	13	22.0	19.900	4	5	9	14	10		14
	14	23.5	21.402	6	7	10	15	12		17
	15	25.0	22.906	6	7	12	17	12		22
	16	26.5	24.412	8	9	12	18	12		23
	17	28.0	25.918	8	9	14	20	14		32
	18	29.5	27.426	8	9	14	22	14		40
	19	31.0	28.935	8	9	15	23	14		44
	20	32.5	30.444	8	9	15	24	14		49
	21	34.0	31.954	8	9	17	26	14		57
	22	35.5	33.465	8	9	17	27	14		62
	23	37.5	34.976	8	9	17	28	14		68
	24	39.0	36.487	8	9	20	30	16		88
	25	40.5	37.999	8	9	20	32	16		100
	26	42.0	39.511	10	11	22	33	16		104
	27	43.5	41.023	10	11	25	35	16		117
	28	45.0	42.536	10	11	25	37	16		131
	29	46.5	44.049	10	11	25	38	16		139
	30	48.0	45.562	10	11	25	39	16		147
	31	49.5	47.075	10	11	25	40	18		175
	32	51.0	48.588	10	11	25	40	18		176
	33	52.5	50.102	10	11	25	40	18		178
	34	54.0	51.616	10	11	25	40	18		180
	35	55.5	53.130	10	11	25	40	18		182

Caution

* The tolerance on the prepared hole diameter d has an H10 finish.