

NK100B/NK100C

Order Product Code

NK100B 20

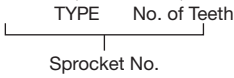

Ground Specification

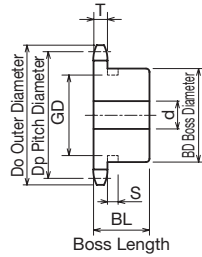

Welded Specification
(Black stain also mixed in)

Boss Length

B-Type Ground Specification

- Chain **No.100**
- Chain Pitch **(P) 31.75mm**
- Roller Link Inner Width ... **(W) 19.05mm**
- Roller Outside Diameter ... **(Dr) 19.05mm**
- Tooth Width **(T) 17.6 mm**

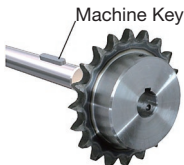
Sprocket No.		Do	Dp	Shaft Hole Diameter d			BD	BL	Shape	Tooth Section	Weight kg
TYPE	No. of Teeth			Prepared Hole	Minimum	Maximum					
NK100B	9	106	92.831	20	21	40	★70	50	Ground Specification	Carbon Structural Steel High-frequency Hardened Teeth	1.6
	10	117	102.745	20	21	45	65	50			1.9
	11	127	112.696	20	21	51	75	50			2.3
	12	138	122.673	20	21	57	86	50			2.9
	13	148	132.670	20	21	63	94	50			3.1
	14	158	142.683	20	21	66	98	50			3.6
	15	168	152.709	20	21	66	98	50			4.2
	16	179	162.745	20	21	66	98	50			4.6
	17	189	172.790	20	21	75	107	50			5.3
	18	199	182.841	20	21	75	107	50			5.7
	19	209	192.898	20	21	75	107	50			6.1
	20	220	202.960	20	21	75	107	50			6.5
	21	230	213.027	20	21	75	107	50			7.0
	22	240	223.097	26	27	80	117	56			7.9
	23	250	233.170	26	27	80	117	56			8.5
	24	260	243.246	26	27	80	117	56			8.8
	25	270	253.325	26	27	80	117	56			9.3
	26	281	263.405	26	27	80	117	56			9.8
	27	291	273.488	26	27	80	117	56			10.3
	28	301	283.572	26	27	80	117	56			10.9
	29	311	293.658	26	27	80	117	56			11.5
	30	321	303.745	26	27	80	117	56			12.1



Use together with the KANA machine key.
Refer to P.334 to P.335

Standard Sprocket B-type/C-type

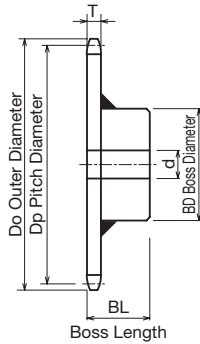

B-Type **Welded Specification**

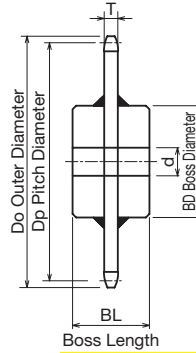

C-Type **Welded Specification**

Sprocket No. TYPE	No. of Teeth	Do	Dp	Shaft Hole Diameter d		BD	BL	Shape	Tooth Section	Weight kg
				Prepared Hole	Minimum Maximum					
NK100B	32	341	323.923	26	27	80	117	56	Ground Specification Chain Structural Steel High-Tenacity/Heat-treated Steel	14.5
	33	352	334.013	26	27	80	117	56		16.1
	34	362	344.105	26	27	80	117	56		16.6
	35	372	354.197	26	27	89	127	63		17.5
	36	382	364.290	26	27	89	127	63	Welded Specification Common Steel	18.0
	37	392	374.384	26	27	89	127	63		18.9
	38	402	384.479	26	27	89	127	63		19.5
	39	412	394.574	26	27	89	127	63		20.0
	40	422	404.669	26	27	89	127	63		20.4
	41	433	414.766	26	27	89	127	63		21.5
	42	443	424.862	26	27	89	127	63		22.6
	45	473	455.155	26	27	89	127	63		24.7
	47	493	475.352	26	27	89	127	63		26.7
	48	503	485.451	26	27	89	127	63		27.5
	50	524	505.650	26	27	89	127	63		30.0
54	564	546.050	26	27	103	147	80	37.4		
55	574	556.151	26	27	103	147	80	41.6		
60	625	606.657	26	27	103	147	80	44.3		
65	675	657.168	26	27	103	147	80	54.5		
NK100C	70	726	707.681	26	27	103	147	100	Welded Specification Common Steel	64.7
	75	777	758.197	30	31	103	147	100		72.7

Sprockets with a ★ symbol for BD have a channel in the boss exterior.

No. of Teeth	S	GD
9	11.5	55

