

K80B

K Sprocket Former B-type

Order Product Code

K80B 15

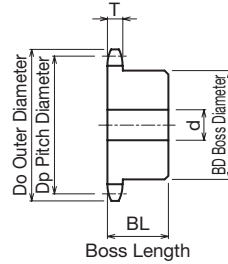
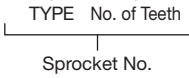

- Chain **No.80**
- Chain Pitch **(P) 25.4 mm**
- Roller Link Inner Width **(W) 15.88 mm**
- Roller Outside Diameter **(Dr) 15.88 mm**
- Tooth Width **(T) 14.6 mm**

- **m** Carbon Structural Steel
- **h** High-frequency Hardened Teeth

TYPE	No. of Teeth	Do	Dp	Shaft Hole Diameter d			BD	BL	Shape	Weight kg
				Prepared Hole	Minimum	Maximum				
K80B	10	93	82.196	15	16	32	55	50	Ground Specification	1.50
	11	102	90.156	15	16	38	60	50		1.70
	12	110	98.138	15	16	46	69	50		1.90
	13	118	106.136	16	17	51	77	50		2.10
	14	127	114.147	16	17	55	80	50		2.40
	15	135	122.167	20	21	55	80	50		2.60
	16	143	130.196	20	21	55	80	50		3.00
	17	151	138.232	20	21	60	90	50		3.30
	18	159	146.273	20	21	60	90	50		3.50
	19	167	154.319	20	21	60	90	50		3.70
	20	176	162.368	20	21	60	90	50		4.30
21	184	170.421	20	21	60	90	50	4.40		



Use together with the KANA machine key. Refer to P.334 to P.335