

K60B

K Sprocket Former B-type

Order Product Code

K60B 15

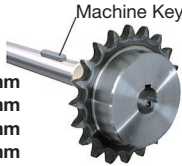
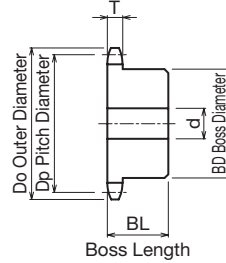
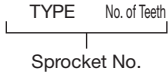

- Chain **No.60**
- Chain Pitch (**P**) **19.05 mm**
- Roller Link Inner Width (**W**) **12.70 mm**
- Roller Outside Diameter (**Dr**) **11.91 mm**
- Tooth Width (**T**) **11.7 mm**

Use together with the KANA machine key. Refer to P.334 to P.335

- m** Carbon Structural Steel
- h** High-frequency Hardened Teeth

TYPE	No. of Teeth	Do	Dp	Shaft Hole Diameter d			BD	BL	Shape	Weight kg
				Prepared Hole	Minimum	Maximum				
K60B	10	70	61.647	13	14	22	39	40	Ground Specification	0.60
	11	76	67.617	13	14	28	45	40		0.70
	12	83	73.604	13	14	32	51	40		0.80
	13	89	79.602	13	14	35	56	40		0.90
	14	95	85.610	16	17	35	56	40		1.00
	15	101	91.625	16	17	35	56	40		1.10
	16	107	97.647	16	17	35	56	40		1.20
	17	113	103.674	16	17	46	70	40		1.60
	18	119	109.705	16	17	46	70	40		1.90
	19	126	115.739	16	17	46	70	40		2.10
	20	132	121.776	16	17	55	80	45		2.40
	21	138	127.816	16	17	55	80	45		2.50
	22	144	133.858	16	17	55	80	45		2.60
	23	150	139.902	16	17	55	80	45		2.80
	24	156	145.948	18	19	55	80	45		3.00
	25	162	151.995	18	19	55	80	45		3.20
	26	168	158.043	18	19	55	80	45		3.30
	27	174	164.093	18	19	55	80	45		3.50
	28	180	170.143	18	19	57	85	50		3.50
	29	187	176.195	18	19	57	85	50		3.60
	30	193	363.994	18	19	57	85	50		4.00