

K410B

Standard Sprocket B-type

Order Product Code

K410B 15

TYPE No. of Teeth
Sprocket No.

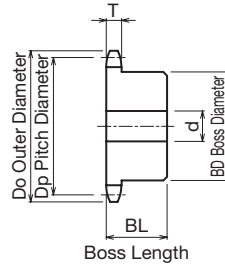

Use together
with the KANA machine key.
Refer to P.334 to P.335

- ChainNo.410
- Chain Pitch(P) 12.70mm
- Roller Link Inner Width(W) 3.40mm
- Roller Outside Diameter(Dr) 7.75mm
- Tooth Width(T) 2.8 mm

m Carbon Structural Steel

TYPE	No. of Teeth	Do	Dp	Shaft Hole Diameter d			BD	BL	Shape	Weight kg
				Prepared Hole	Minimum	Maximum				
K410B	10	47	41.098	9	10	16	28	20	Ground Specification	0.14
	11	51	45.078	10	11	16	30	20		0.19
	12	55	49.069	10	11	18	34	20		0.22
	13	59	53.068	12	13	20	38	20		0.23
	14	63	57.073	12	13	25	42	20		0.28
	15	67	61.084	12	13	28	46	20		0.34
	16	71	65.098	13	14	30	50	20		0.40
	17	76	69.116	13	14	32	54	22		0.46
	18	80	73.136	13	14	35	57	22		0.51
	19	84	77.159	13	14	40	62	22		0.59
	20	88	81.184	14	15	45	67	25		0.76
	21	92	85.211	14	15	48	71	25		0.85
	22	96	89.239	14	15	51	75	25		0.95
	23	100	93.268	14	15	51	77	25		1.00
	24	104	97.298	14	15	42	63	25		0.84
	25	108	101.330	14	15	42	63	25		0.88
	26	112	105.362	14	15	42	63	25		0.92
	27	116	109.395	14	15	42	63	25		0.96
	28	120	113.429	14	15	42	63	25		1.00
	29	124	117.463	14	15	42	63	25		1.00
	30	128	121.498	14	15	42	63	25		1.10
	32	137	129.569	14	15	45	68	28		1.30
	34	145	137.642	14	15	45	68	28		1.30
	35	149	141.679	14	15	45	68	28		1.40
36	153	145.716	16	17	45	68	28	1.50		
40	169	161.868	16	17	45	68	28	1.70		