

K40B

K Sprocket Former B-type

Order Product Code

K40B 20

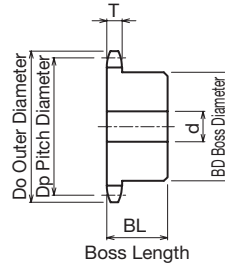
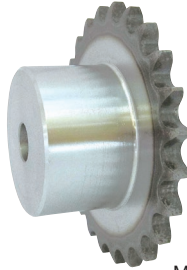
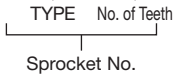

- Chain **No.40**
- Chain Pitch **(P) 12.70 mm**
- Roller Link Inner Width **(W) 7.95 mm**
- Roller Outside Diameter **(Dr) 7.92 mm**
- Tooth Width **(T) 7.2 mm**

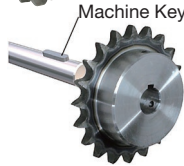

Use together with the KANA machine key. Refer to P.334 to P.335

- **m** Carbon Structural Steel
- **h** High-frequency Hardened Teeth

TYPE	No. of Teeth	Do	Dp	Shaft Hole Diameter d			BD	BL	Shape	Weight kg
				Prepared Hole	Minimum	Maximum				
K40B	10	47	41.098	9	10	16	28	25	Ground Specification	0.20
	11	51	45.078	10	11	16	30	25		0.20
	12	55	49.069	10	11	18	34	25		0.25
	13	59	53.068	12	13	20	38	25		0.25
	14	63	57.073	12	13	25	42	25		0.30
	15	67	61.084	12	13	28	46	25		0.35
	16	71	65.098	13	14	30	50	25		0.40
	17	76	69.116	13	14	32	54	30		0.55
	18	80	73.136	13	14	32	54	30		0.60
	19	84	77.159	14	15	32	54	30		0.65
	20	88	81.184	14	15	35	56	40		0.75
	21	92	85.211	14	15	35	56	40		0.80
	22	96	89.239	14	15	35	56	40		0.90
	23	100	93.268	14	15	35	56	40		1.00
	24	104	97.298	14	15	35	56	40		1.10
	25	108	101.330	14	15	35	56	40		1.15
	26	112	105.362	14	15	35	56	40		1.20
	27	116	109.395	14	15	45	65	40		1.25
	28	120	113.429	14	15	45	65	40		1.30
	29	124	117.463	14	15	45	65	40		1.40
	30	128	121.498	14	15	45	65	40		1.50
	31	133	125.533	14	15	45	65	40		1.70
	32	137	129.569	14	15	45	65	40		1.70
	33	141	133.605	14	15	45	65	40		1.75
	34	145	137.642	14	15	45	65	40		1.75
	35	149	141.679	14	15	45	65	40		1.75
	36	153	145.716	16	17	45	68	35		1.80
	37	157	149.754	16	17	45	68	35		1.85
	38	161	153.791	16	17	45	68	35		1.90
	39	165	157.830	16	17	45	68	35		1.96
	40	169	161.868	16	17	45	68	35		2.03