

K25B

● Order Product Code

K25B 16

TYPE No. of Teeth
Sprocket No.

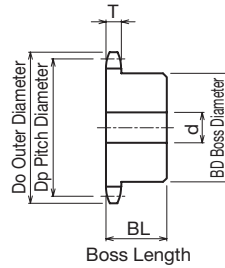

- Chain **No.25**
- Chain Pitch **(P) 6.35 mm**
- Bushing Link Inner Width **(W) 3.18 mm**
- Bushing Outside Diameter **(Dr) 3.30 mm**
- Tooth Width **(T) 2.8 mm**

m Carbon Structural Steel

TYPE	No. of Teeth	Do	Dp	Shaft Hole Diameter d			BD	BL	Shape	Weight g
				Prepared Hole	Minimum	Maximum				
K25B	10	23	20.549	6	7	8	14	15	Ground Specification	30
	11	25	22.539	7	8	8	15	15		30
	12	28	24.535	7	8	9	15	15		30
	13	30	26.534	7	8	10	18	15		50
	14	32	28.537	7	8	10	20	15		50
	15	34	30.542	7	8	10	20	15		50
	16	36	32.549	9	10	12	25	15		60
	17	38	34.558	9	10	12	25	15		70
	18	40	36.568	9	10	12	25	15		70
	19	42	38.580	9	10	16	28	15		80
	20	44	40.592	9	10	16	28	15		80
	21	46	42.605	9	10	16	28	15		90
	22	48	44.619	9	10	16	30	15		100
	23	50	46.634	9	10	16	30	15		110
	24	52	48.649	9	10	16	30	15		120
	25	54	50.665	9	10	20	35	15		140
	26	56	52.681	9	10	20	35	15		140
	27	58	54.698	9	10	20	35	15		150
	28	60	56.714	9	10	20	35	15		150
	29	62	58.732	9	10	20	35	15		160
	30	64	60.749	9	10	20	35	15		160
	31	66	62.767	10	11	22	40	20		200
	32	68	64.785	10	11	22	40	20		200
	33	70	66.803	10	11	22	40	20		210
	34	72	68.821	10	11	22	40	20		210

Standard Sprocket B-type

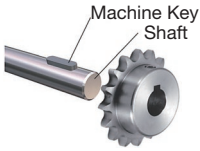

Use together with the KANA machine key.
Refer to P.334 to P.335

m Carbon Structural Steel

TYPE	No. of Teeth	Do	Dp	Shaft Hole Diameter d			BD	BL	Shape	Weight g
				Prepared Hole	Minimum	Maximum				
K25B	35	74	70.839	10	11	22	40	20	Ground Specification	210
	36	76	72.858	10	11	22	40	20		220
	37	78	74.877	10	11	22	40	20		260
	38	80	76.896	10	11	22	40	20		260
	39	82	78.915	10	11	22	40	20		270
	40	84	80.934	10	11	22	40	20		270
	41	87	82.953	11	12	30	50	20		320
	42	89	84.972	11	12	30	50	20		320
	43	91	86.992	11	12	30	50	20		400
	44	93	89.011	11	12	30	50	20		410
	45	95	91.031	11	12	30	50	20		410
	48	101	97.090	11	12	30	50	20		430
	50	105	101.130	11	12	30	50	20		460
	54	113	109.210	11	12	30	50	20		470
	60	125	121.331	11	12	30	50	20		520
	65	135	131.434	12	13	30	50	30		720
70	145	141.536	12	13	30	50	30	770		
75	155	151.639	12	13	30	50	30	820		
80	165	161.743	12	13	30	50	30	880		