

HG60B**HG High-grade Sprocket with Hardened Teeth B-type**● **Order No. Example****HG60B 42H**

Type No. of Teeth
 └──────────┬──────────┘
 Sprocket No.

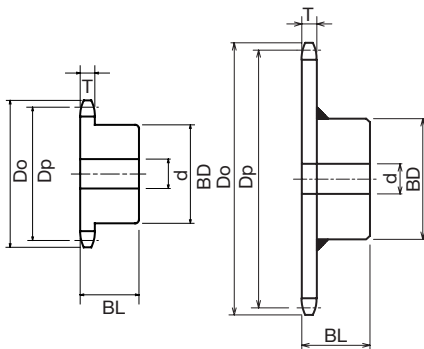

- Chain No.60
- Chain Pitch (P)19.05mm
- Roller Link Inner Width (W)12.70mm
- Roller Outside Diameter (Dr)11.91mm
- Tooth Width (T)11.7 mm

m Carbon Structural Steel**h** High-frequency Hardened Teeth

Type	No. of Teeth	Outer Diameter Do	Pitch Diameter Dp	Shaft Hole Diameter d			Boss Diameter BD	Boss Length BL	Shape	Weight kg	¥	Semi-F ¥
				Prepared Hole Product	Minimum	Maximum						
HG 60B	31H	199	188.30	20	21	55	83	40	Ground Specification	3.64		
	32H	205	194.35	20	21	55	83	40		3.80		
	33H	211	200.41	20	21	55	83	40		4.00		
	34H	217	206.46	20	21	55	83	40		4.15		
	35H	223	212.52	20	21	55	83	40		4.33		
	36H	229	218.57	20	21	55	83	40	4.52			
	38H	241	230.69	20	21	55	83	40	4.90			
	40H	253	242.80	20	21	55	83	40	5.30			
	42H	266	254.92	20	21	63	93	45	Welded Specification	6.40		
	45H	284	273.09	20	21	63	93	45		7.10		
48H	302	291.27	20	21	63	93	45	7.85				
50H	314	303.39	20	21	63	93	45	8.40				



Order Method

Sprocket No. and Quantity



Guide

* Since we also manufacture sizes other than those in the catalog, and machine shaft holes/keys/taps, etc., depending on your request, please contact our company's sales office for details.



Postage

Same-day shipping

* Please refer to P24 to P33 for the Semi-F Series <Complete Product> order method.