

HG160B



HG High-grade Sprocket with Hardened Teeth B-type

● Order No. Example

HG 160B 15H

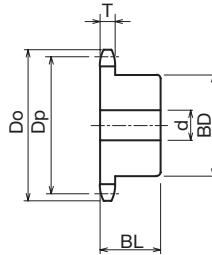
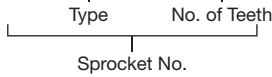

- Chain No.160
- Chain Pitch (P)50.80mm
- Roller Link Inner Width (W)31.75mm
- Roller Outside Diameter (Dr)28.58mm
- Tooth Width (T)29.4 mm

- m Carbon Structural Steel
- h High-frequency Hardened Teeth

Type	No. of Teeth	Outer Diameter Do	Pitch Diameter Dp	Shaft Hole Diameter d			Boss Diameter BD	Boss Length BL	Shape	Weight kg	¥	Semi-F ¥
				Prepared Hole Product	Minimum	Maximum						
HG 160B	10H	186	164.39	26	27	70	105	63	Ground Specification	6.80		
	11H	204	180.31	26	27	80	117	63		8.30		
	12H	220	196.28	26	27	89	127	63		9.90		
	13H	237	212.27	26	27	95	137	71		12.50		
	14H	253	228.30	26	27	95	137	71		13.80		
	15H	269	244.33	30	31	95	137	71		15.20		
	16H	286	260.39	30	31	103	147	71		17.40		
	17H	302	276.46	30	31	103	147	71		18.90		
	18H	319	292.55	30	31	103	147	71		20.60		
	19H	335	308.64	30	31	103	147	71		22.30		
	20H	351	324.74	30	31	103	147	71		24.20		
21H	368	340.84	30	31	103	147	71	26.10				



Order Method

Sprocket No. and Quantity



Postage

Same-day shipping



Guide

* Since we also manufacture sizes other than those in the catalog, and machine shaft holes/keys/taps, etc., depending on your request, please contact our company's sales office for details.

* Please refer to P24 to P33 for the Semi-F Series <Complete Product> order method.