

HG 120B



HG High-grade Sprocket with Hardened Teeth B-type

● Order No. Example

HG 120B 25H

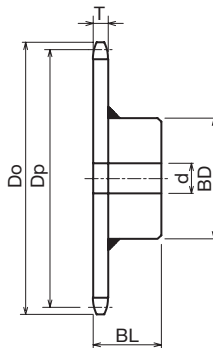
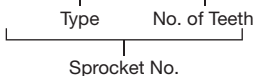

- ChainNo.120
- Chain Pitch(P)38.10mm
- Roller Link Inner Width(W)25.40mm
- Roller Outside Diameter(Dr)22.23mm
- Tooth Width(T)23.5 mm

- m Carbon Structural Steel
- h High-frequency Hardened Teeth

Type	No. of Teeth	Outer Diameter Do	Pitch Diameter Dp	Shaft Hole Diameter d			Boss Diameter BD	Boss Length BL	Shape	Weight kg	¥	Semi-F ¥
				Prepared Hole Product	Minimum	Maximum						
HG 120B	22H	288	267.72	26	27	89	127	63	Welded Specification	13.40		
	23H	300	279.80	26	27	89	127	63		14.50		
	24H	312	291.90	26	27	89	127	63		15.20		
	25H	324	303.99	26	27	89	127	63		16.20		
	26H	337	316.09	26	27	89	127	63		17.20		
	28H	361	340.29	26	27	95	137	71		20.90		
	30H	385	364.50	26	27	95	137	71	23.20			



Order Method

Sprocket No. and Quantity



Postage

Same-day shipping



Guide

* Since we also manufacture sizes other than those in the catalog, and machine shaft holes/keys/taps, etc., depending on your request, please contact our company's sales office for details.

* Please refer to P24 to P33 for the Semi-F Series <Complete Product> order method.