

# FBN25B

## Order Product Code

(Part is a special shaft diameter specification only)

**FBN25B17D10 K4**

TYPE No. of Teeth  $\phi D^{H7}$  Keyway  
Sprocket No.

- Chain ..... **No.25**
- Chain Pitch ..... **(P) 6.35 mm**
- Bushing Link Inner Width ..... **(W) 3.18 mm**
- Bushing Outside Diameter ..... **(Dr) 3.30 mm**
- Tooth Width ..... **(T) 2.8 mm**



### ☆ Special Shaft Hole Machined Specification

$\phi D^{H7}$	Keyway $b \times t^2$	Set screw M
10	4x1.8	4

\* Parts only can be selected for special shaft hole machining.

TYPE	FBN25B <span style="float: right;">m Carbon Structural Steel</span>										
Product Code	No. of Teeth	$\phi D^{H7}$	Keyway $b \times t^2$	M	Do	Dp	BD	BL	a	Weight g	
FBN25B13D10	13	10	3x1.4	4	30.0	26.534	18	15	6	50	
FBN25B16D10	16	10	3x1.4	4	36.0	32.549	25	15	6	60	
FBN25B16D10K4	16	10	4x1.8	4	36.0	32.549	25	15	6	60	
FBN25B16D12	16	12	4x1.8	5	36.0	32.549	25	15	6	60	
FBN25B17D10	17	10	3x1.4	4	38.0	34.558	25	15	6	70	
FBN25B17D10K4	17	10	4x1.8	4	38.0	34.558	25	15	6	70	
FBN25B17D12	17	12	4x1.8	5	38.0	34.558	25	15	6	70	
FBN25B18D10	18	10	3x1.4	4	40.0	36.568	25	15	6	70	
FBN25B18D10K4	18	10	4x1.8	4	40.0	36.568	25	15	6	70	
FBN25B18D12	18	12	4x1.8	5	40.0	36.568	25	15	6	70	
FBN25B19D10	19	10	3x1.4	4	42.0	38.580	28	15	6	80	
FBN25B19D10K4	19	10	4x1.8	4	42.0	38.580	28	15	6	80	
FBN25B19D12	19	12	4x1.8	5	42.0	38.580	28	15	6	80	
FBN25B19D15	19	15	5x2.3	6	42.0	38.580	28	15	6	80	
FBN25B20D10	20	10	3x1.4	4	44.0	40.592	28	15	6	80	
FBN25B20D10K4	20	10	4x1.8	4	44.0	40.592	28	15	6	80	
FBN25B20D12	20	12	4x1.8	5	44.0	40.592	28	15	6	80	
FBN25B20D15	20	15	5x2.3	6	44.0	40.592	28	15	6	80	
FBN25B21D10	21	10	3x1.4	4	46.0	42.605	28	15	6	90	
FBN25B21D10K4	21	10	4x1.8	4	46.0	42.605	28	15	6	90	
FBN25B21D12	21	12	4x1.8	5	46.0	42.605	28	15	6	90	
FBN25B21D15	21	15	5x2.3	6	46.0	42.605	28	15	6	90	
FBN25B22D12	22	12	4x1.8	5	48.0	44.619	30	15	6	100	
FBN25B22D15	22	15	5x2.3	6	48.0	44.619	30	15	6	100	
FBN25B23D10	23	10	3x1.4	4	50.0	46.634	30	15	6	110	
FBN25B23D12	23	12	4x1.8	5	50.0	46.634	30	15	6	110	
FBN25B23D15	23	15	5x2.3	6	50.0	46.634	30	15	6	110	
FBN25B24D12	24	12	4x1.8	5	52.0	48.649	30	15	6	120	
FBN25B24D15	24	15	5x2.3	6	52.0	48.649	30	15	6	120	
FBN25B25D12	25	12	4x1.8	5	54.0	50.665	35	15	6	140	
FBN25B25D15	25	15	5x2.3	6	54.0	50.665	35	15	6	140	
FBN25B25D16	25	16	5x2.3	6	54.0	50.665	35	15	6	140	
FBN25B26D12	26	12	4x1.8	5	56.0	52.681	35	15	6	140	
FBN25B26D15	26	15	5x2.3	6	56.0	52.681	35	15	6	140	
FBN25B26D16	26	16	5x2.3	6	56.0	52.681	35	15	6	140	
FBN25B27D12	27	12	4x1.8	5	58.0	54.698	35	15	6	150	
FBN25B27D15	27	15	5x2.3	6	58.0	54.698	35	15	6	150	
FBN25B27D16	27	16	5x2.3	6	58.0	54.698	35	15	6	150	

\*M is a set screw. \* The seal set screws differ from the usual due to the boss type.

## FBN Finished Bore Sprocket

## D10 K4x1.8 Specification FBN Finished Bore Sprocket New JIS Keyway Specification

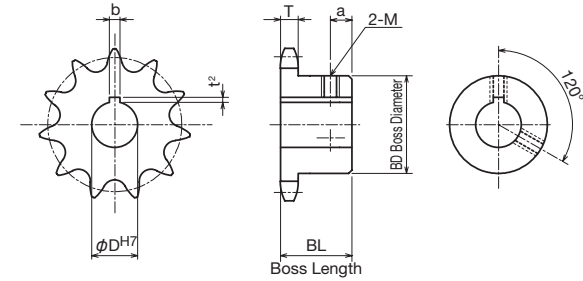

TYPE	FBN25B <span style="float: right;">m Carbon Structural Steel</span>										
Product Code	No. of Teeth	$\phi D^{H7}$	Keyway $b \times t^2$	M	Do	Dp	BD	BL	a	Weight g	
FBN25B28D10	28	10	3x1.4	4	60.0	56.714	35	15	6	150	
FBN25B28D12	28	12	4x1.8	5	60.0	56.714	35	15	6	150	
FBN25B28D15	28	15	5x2.3	6	60.0	56.714	35	15	6	150	
FBN25B28D16	28	16	5x2.3	6	60.0	56.714	35	15	6	150	
FBN25B30D12	30	12	4x1.8	5	64.0	60.749	35	15	6	160	
FBN25B30D15	30	15	5x2.3	6	64.0	60.749	35	15	6	160	
FBN25B30D16	30	16	5x2.3	6	64.0	60.749	35	15	6	160	
FBN25B32D15	32	15	5x2.3	6	68.0	64.785	40	20	8	200	
FBN25B32D16	32	16	5x2.3	6	68.0	64.785	40	20	8	200	
FBN25B32D18	32	18	6x2.8	6	68.0	64.785	40	20	8	200	
FBN25B32D20	32	20	6x2.8	6	68.0	64.785	40	20	8	200	
FBN25B34D15	34	15	5x2.3	6	72.0	68.821	40	20	8	210	
FBN25B34D16	34	16	5x2.3	6	72.0	68.821	40	20	8	210	
FBN25B34D18	34	18	6x2.8	6	72.0	68.821	40	20	8	210	
FBN25B34D20	34	20	6x2.8	6	72.0	68.821	40	20	8	210	
FBN25B35D15	35	15	5x2.3	6	74.0	70.839	40	20	8	210	
FBN25B35D16	35	16	5x2.3	6	74.0	70.839	40	20	8	210	
FBN25B35D18	35	18	6x2.8	6	74.0	70.839	40	20	8	210	
FBN25B35D20	35	20	6x2.8	6	74.0	70.839	40	20	8	210	
FBN25B36D15	36	15	5x2.3	6	76.0	72.858	40	20	8	220	
FBN25B36D16	36	16	5x2.3	6	76.0	72.858	40	20	8	220	
FBN25B36D18	36	18	6x2.8	6	76.0	72.858	40	20	8	220	
FBN25B36D20	36	20	6x2.8	6	76.0	72.858	40	20	8	220	
FBN25B38D15	38	15	5x2.3	6	80.0	76.896	40	20	8	260	
FBN25B38D16	38	16	5x2.3	6	80.0	76.896	40	20	8	260	
FBN25B38D18	38	18	6x2.8	6	80.0	76.896	40	20	8	260	
FBN25B38D20	38	20	6x2.8	6	80.0	76.896	40	20	8	260	
FBN25B40D15	40	15	5x2.3	6	84.0	80.934	40	20	8	270	
FBN25B40D16	40	16	5x2.3	6	84.0	80.934	40	20	8	270	
FBN25B40D18	40	18	6x2.8	6	84.0	80.934	40	20	8	270	
FBN25B40D20	40	20	6x2.8	6	84.0	80.934	40	20	8	270	

\*M is a set screw. \* The seal set screws differ from the usual due to the boss type.



\* If you order a special shaft diameter specification, please append K4 after the hole diameter.

Example: FBN25B16D10K4