

FBN2040B

FBN Double Pitch Sprocket for S Rollers New JIS Keyway Specification

Order Product Code FBN2040B91/2D20

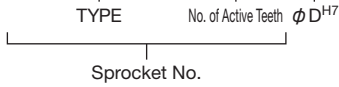

- Chain **No.C2040**
- Chain Pitch **(P) 25.4mm**
- Roller Link Inner Width **(W) 7.95mm**
- Roller Outside Diameter **(Dr) 7.92mm**
- Tooth Width **(T) 7.2 mm**

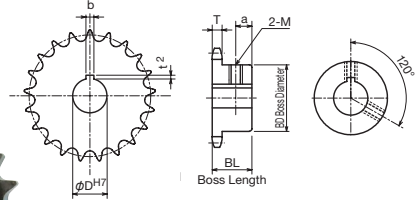

- m** Carbon Structural Steel
- h** High-frequency Hardened Teeth

TYPE	FBN2040B										
Product Code	No. of Active Teeth	Actual No. of Teeth	ϕ D ^{H7}	Keyway b×t ²	M	Do	Dp	BD	BL	a	Weight kg
FBN2040B91/2D20	9 1/2	19	20	6×2.8	6	84.0	154.319	60	25	7	0.61
FBN2040B91/2D25	9 1/2	19	25	8×3.3	8	84.0	154.319	60	25	7	0.61
FBN2040B91/2D30	9 1/2	19	30	8×3.3	8	84.0	154.319	60	25	7	0.61
FBN2040B91/2D35	9 1/2	19	35	10×3.3	8	84.0	154.319	60	25	7	0.61
FBN2040B91/2D40	9 1/2	19	40	12×3.3	8	84.0	154.319	60	25	7	0.61
FBN2040B101/2D20	10 1/2	21	20	6×2.8	6	92.0	170.421	69	25	7	0.82
FBN2040B101/2D25	10 1/2	21	25	8×3.3	8	92.0	170.421	69	25	7	0.82
FBN2040B101/2D30	10 1/2	21	30	8×3.3	8	92.0	170.421	69	25	7	0.82
FBN2040B101/2D35	10 1/2	21	35	10×3.3	8	92.0	170.421	69	25	7	0.82
FBN2040B101/2D40	10 1/2	21	40	12×3.3	8	92.0	170.421	69	25	7	0.82
FBN2040B111/2D20	11 1/2	23	20	6×2.8	6	100.0	186.536	77	25	7	0.98
FBN2040B111/2D25	11 1/2	23	25	8×3.3	8	100.0	186.536	77	25	7	0.98
FBN2040B111/2D30	11 1/2	23	30	8×3.3	8	100.0	186.536	77	25	7	0.98
FBN2040B111/2D35	11 1/2	23	35	10×3.3	8	100.0	186.536	77	25	7	0.98
FBN2040B111/2D40	11 1/2	23	40	12×3.3	8	100.0	186.536	77	25	7	0.98
FBN2040B121/2D20	12 1/2	25	20	6×2.8	6	108.0	202.660	63	25	7	0.83
FBN2040B121/2D25	12 1/2	25	25	8×3.3	8	108.0	202.660	63	25	7	0.83
FBN2040B121/2D30	12 1/2	25	30	8×3.3	8	108.0	202.660	63	25	7	0.83
FBN2040B121/2D35	12 1/2	25	35	10×3.3	8	108.0	202.660	63	25	7	0.83
FBN2040B121/2D40	12 1/2	25	40	12×3.3	8	108.0	202.660	63	25	7	0.83

*M is a set screw. * The seal set screws differ from the usual due to the boss type.

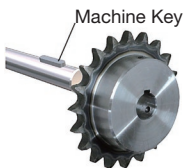

Use together with the KANA machine key. Refer to P.334 to P.335