

2060B

Standard Double Pitch Sprocket for S Rollers B-type

Order Product Code

2060B 6 1/2

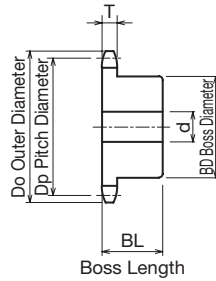
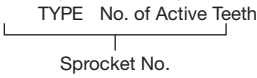

- Chain **No.C2060H**
- Chain Pitch **(P) 38.10 mm**
- Roller Link Inner Width **(W) 12.70 mm**
- Roller Outside Diameter **(Dr) 11.91 mm**
- Tooth Width **(T) 11.7 mm**

- m** Carbon Structural Steel
- h** High-frequency Hardened Teeth

TYPE	No. of Active Teeth	Actual No. of Teeth	Do	Dp	Shaft Hole Diameter d			BD	BL	Weight kg
					Prepared Hole	Minimum	Maximum			
2060B	6 1/2	13	88	81.984	14	15	32	53	32	0.73
	7 1/2	15	101	93.672	16	17	45	66	32	1.05
	8 1/2	17	113	105.470	16	17	48	73	32	1.33
	9 1/2	19	126	117.339	16	17	55	83	40	2.03
	10 1/2	21	138	129.260	16	17	55	83	40	2.23
	11 1/2	23	150	141.217	16	17	55	83	45	2.56
	12	24	156	147.207	18	19	55	83	45	2.90
	12 1/2	25	162	153.203	18	19	55	83	45	2.81



Use together with the KANA machine key.
Refer to P.334 to P.335